

Standard Features

- ◆ Heavy gauge aluminum headboards with stainless steel liners and hand-sewn metal slug(s) or slide(s) depending on application
- ◆ Battens semi-full length
- ◆ Luff and foot attachments attached with hand-sewn webbing
- ◆ Reef rings are stainless steel/composite pressed rings
- ◆ Corner rings are webbed Stainless Steel external rings.
- ◆ Batten pockets finished with our Internal Velcro system, but the Tradeswind specification is available
- ◆ All seams will have 2 to 3 rows of 3-step stitching, depending on application
- ◆ Challenge Sailcloth High Modulus Fabrics
- ◆ Patches are Block style
- ◆ Polyester Leechline
- ◆ Tell-tales at each batten pocket
- ◆ Heavy Duty sailbag

Battens step down in length and do not contact luff, reducing compression loads and need for expensive luff hardware.

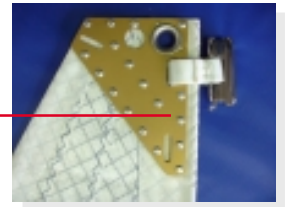

Extra strong double aluminum headboards featuring hand sewn metal slide(s) depending on application.

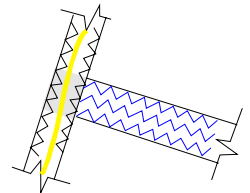

2 or 3 rows of contrasting 3-step stitching and internal leechline chafe guard

Optional Features

- ◆ One or more reefing points
- ◆ Full length battens
- ◆ Seamkote
- ◆ [Tradewinds Specifications](#)
- ◆ Draft stripes, numbers, and insignia
- ◆ Shelf, Flattener, and cunningham

Block patches with reef band connector patch at leech

External corner rings finished with leather and 'capped' webbing straps.



Quality, Service, Value

- ◆ Every sail we build comes with the assurance of a two year warranty of quality, service and value.
- ◆ If you ever need service, our consultants will direct you to the nearest of our worldwide network of Service lofts.
- ◆ No matter where in the world your sailing takes you, we are there to help.
- ◆ For further information, contact your Neil Pryde consultant or visit us at: <http://www.neilprydesails.com>