

Standard Features

- ◆ Corner rings are webbed stainless steel external rings with leather chafe guards or pressed rings with load straps.
- ◆ All seams will have 2 to 3 rows of 3-step stitching, depending on size.
- ◆ Patches block style.
- ◆ Polyester Leech and foot lines.
- ◆ Tell-tails.
- ◆ Heavy Duty sailbag.

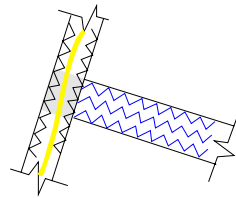

2 or 3 rows of contrasting 3-step stitching and internal leechline chafe guard

Optional Features

- ◆ Seamkote.
- ◆ Sail numbers.
- ◆ Draftstripes.
- ◆ Tradewinds Specifications.
- ◆ Reefs in jibs.

External stainless ring covered with handsewn leather.

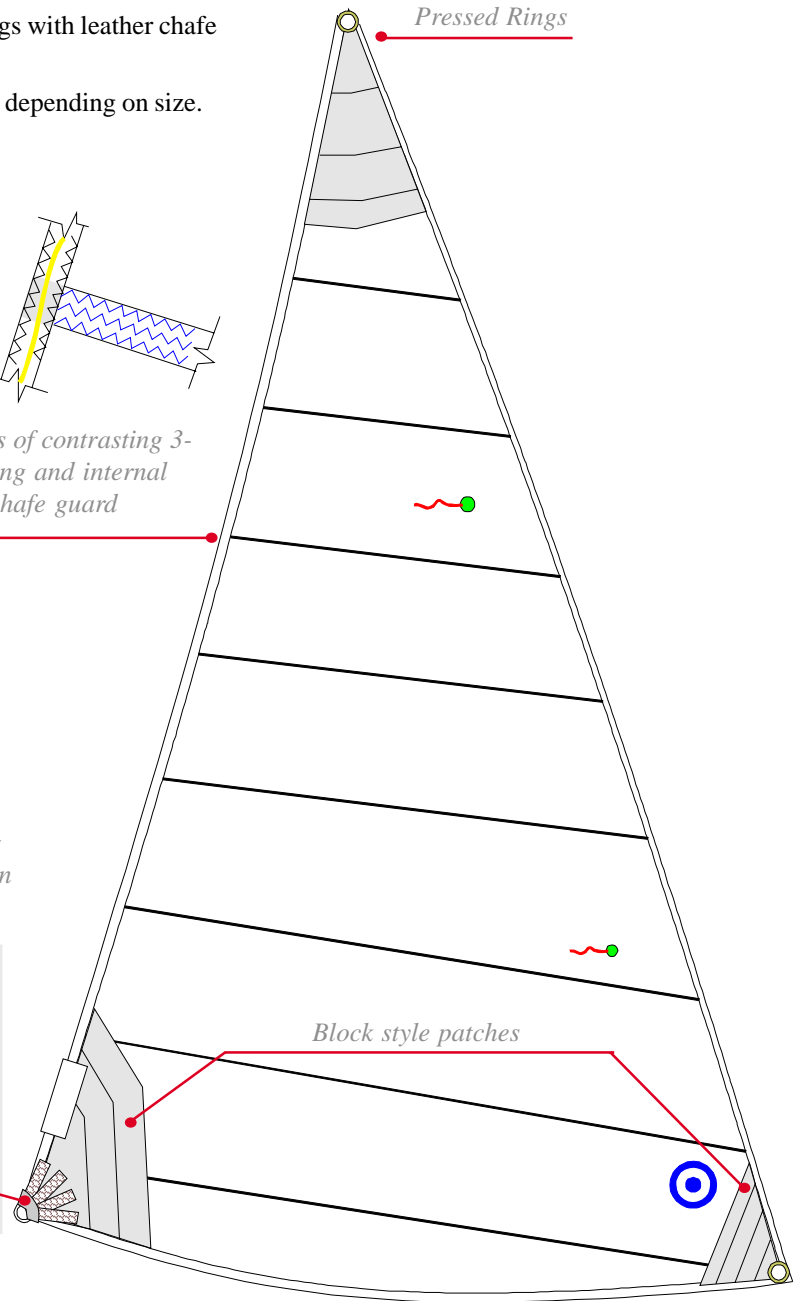

Quality, Service, Value

- ◆ Every sail we build comes with the assurance of a two year warranty of quality, service and value.
- ◆ If you ever need service, our consultants will direct you to the nearest of our worldwide network of Service lofts.
- ◆ No matter where in the world your sailing takes you, we are there to help.
- ◆ For further information, contact your Neil Pryde consultant by dialing 1-203-874-6984 or <http://www.neilprydesails.com>