

Standard Features

- ◆ Head and Tack are webbed with 2-ply webbing.
- ◆ Clew fitted with Roller Block with webbing protected by uv cover
- ◆ Pressed safety clew ring
- ◆ All seams will have 2 to 3 rows of 3-step stitching, depending on size
- ◆ Patches block style with reefing "buffer" patches at Head and Tack
- ◆ Polyester Leech and foot lines
- ◆ Tell-tails
- ◆ Heavy Duty sailbag
- ◆ U.V. sacrificial cover on both sides of exposed clew

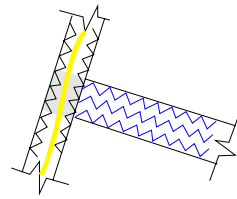

2 or 3 rows of contrasting 3-step stitching and internal leechline chafe guard

Webbing attachment for flexible furling

Optional Features

- ◆ Seamkote
- ◆ Sail numbers
- ◆ Draftstripes
- ◆ Tradewinds Specifications

Block style patches with integrated reefing patch and U.V. covered clew.

Pressed safety ring

Quality, Service, Value

- ◆ Every sail we build comes with the assurance of a two year warranty of quality, service and value.
- ◆ If you ever need service, our consultants will direct you to the nearest of our worldwide network of Service lofts.
- ◆ No matter where in the world your sailing takes you, we are there to help.
- ◆ For further information, contact your Neil Pryde consultant by dialing 1-203-874-6984 or <http://www.neilprydesails.com>